

YALE HINGED SECURITY AND SCREEN DOOR LOCK

FITTING INSTRUCTIONS

All dimensions in millimetres

When fitting lock to a NEW door section, at the desired height, cut out and drill both sides of the door stile to dimensions shown.

Note: If replacing an old lock, the front cut out may require modification.

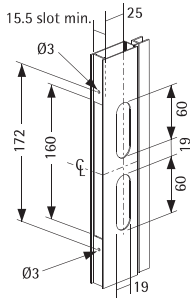

Insert connecting rod into lock body.

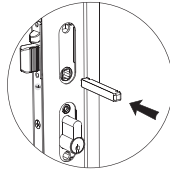

Prepare escutcheon by rotating lever downwards to the required handing position.

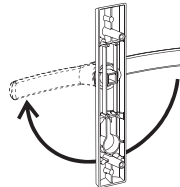

With the door unlocked, hold the door in the closed position and mark the door jamb level with the match mark on the front of the lock body.

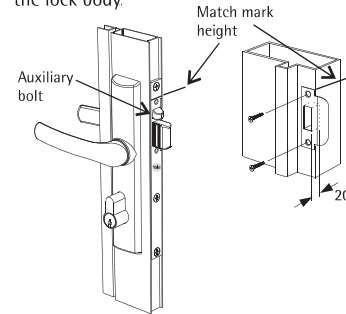

Fit lock body into prepared door section using two 12mm screws.

Important: Ensure main bolt is fully out and deadlocked before fitting cylinder lock. The lock must be mounted in the position shown, as our product warranty cannot be assured if mounted upside down.

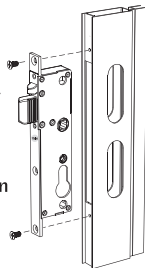

Fit escutcheon plates ensuring snib is at 45° and on the inside face of the door.



Align the top of the striker plate with the mark just made. Mark screw holes and bolt recess position. Ensure the bolt recess for the lock bolt is at least 20mm deep. Secure the striker plate with the two fixing screws supplied. Operation of the lock requires the auxiliary bolt to be depressed against striker plate. Clearance between the door and jamb to be 3mm.

Note: Occasional light lubrication of main bolt is recommended.

Multi-lock accessory kits are available on request as well as 3mm striker packers.

Insert cylinder lock so cam turns towards front of door. Secure cylinder lock body with 32mm screw. Do not overtighten this screw.

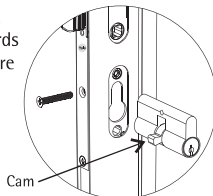

Secure escutcheon plates with 25mm thread forming screws (note these screws form their own thread). Fit mounting hole plugs.

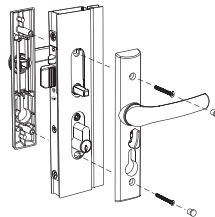

Important:

There are two locking modes - Privacy and Deadlock:

Privacy mode is when the key is rotated 90° and then rotated back, this locks the main bolt and handles however the snib is still functional and can unlock the mechanism.

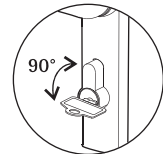

Deadlock mode is when the key is rotated 180° and then rotated back, this deadlocks the main bolt, handles and snib.

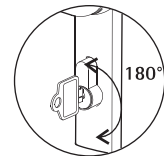

Safe and Secure:

For safety reasons, when the premises are occupied, privacy mode is recommended. If deadlock mode is selected, leave the key in close proximity where all occupants have access to it in case of a fire or an emergency.